

- Print using Avery 5160 (1x2 5/8) label paper
- Be sure to set your scaling on your print page to either "none" or 100%
- Print a single page first to test the alignment before printing all the pages

**75DFF-06-VITON**

06 FACE SEAL O-RING-VITON

*Tompkins Industries, Inc.*



**75DFF-08-VITON-BRO WN**

08 FACE SEAL O-RING-VITON BROWN

*Tompkins Industries, Inc.*



**75DFF-12-VITON**

12 FACE SEAL O-RING-VITON

*Tompkins Industries, Inc.*



**75DFF-16-VITON-BRO WN**

16 FACE SEAL O-RING-VITON BROWN

*Tompkins Industries, Inc.*



**75DFF-24-VITON**

24 FACE SEAL O-RING-VITON

*Tompkins Industries, Inc.*



**90DFF-06**

06 FACE SEAL O-RING

*Tompkins Industries, Inc.*



**90DFF-12**

12 FACE SEAL O-RING

*Tompkins Industries, Inc.*



**90DFF-24**

24 FACE SEAL O-RING

*Tompkins Industries, Inc.*



**FF0304-C-08**

08FORFSX CAP

*Tompkins Industries, Inc.*

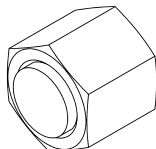

**75DFF-04-VITON**

04 FACE SEAL O-RING-VITON

*Tompkins Industries, Inc.*



**75DFF-06-VITON-BRO WN**

06 FACE SEAL O-RING-VITON BROWN

*Tompkins Industries, Inc.*



**75DFF-10-VITON**

10 FACE SEAL O-RING-VITON

*Tompkins Industries, Inc.*



**75DFF-12-VITON-BRO WN**

12 FACE SEAL O-RING-VITON BROWN

*Tompkins Industries, Inc.*



**75DFF-20-VITON**

20 FACE SEAL O-RING-VITON

*Tompkins Industries, Inc.*



**75DFF-24-VITON-BRO WN**

24 FACE SEAL O-RING-VITON BROWN

*Tompkins Industries, Inc.*



**90DFF-08**

08 FACE SEAL O-RING

*Tompkins Industries, Inc.*



**90DFF-16**

16 FACE SEAL O-RING

*Tompkins Industries, Inc.*



**FF0304-C-04**

04FORFSX CAP

*Tompkins Industries, Inc.*

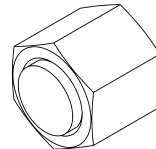

**FF0304-C-10**

10FORFSX CAP

*Tompkins Industries, Inc.*

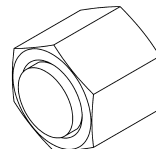

**75DFF-04-VITON-BRO WN**

04 FACE SEAL O-RING-VITON BROWN

*Tompkins Industries, Inc.*



**75DFF-08-VITON**

08 FACE SEAL O-RING-VITON

*Tompkins Industries, Inc.*



**75DFF-10-VITON-BRO WN**

10 FACE SEAL O-RING-VITON BROWN

*Tompkins Industries, Inc.*



**75DFF-16-VITON**

16 FACE SEAL O-RING-VITON

*Tompkins Industries, Inc.*



**75DFF-20-VITON-BRO WN**

20 FACE SEAL O-RING-VITON BROWN

*Tompkins Industries, Inc.*



**90DFF-04**

04 FACE SEAL O-RING

*Tompkins Industries, Inc.*



**90DFF-10**

10 FACE SEAL O-RING

*Tompkins Industries, Inc.*



**90DFF-20**

20 FACE SEAL O-RING

*Tompkins Industries, Inc.*



**FF0304-C-06**

06FORFSX CAP

*Tompkins Industries, Inc.*

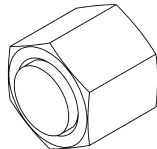

**FF0304-C-12**

12FORFSX CAP

*Tompkins Industries, Inc.*

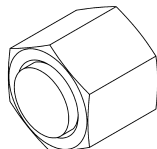

**FF0304-C-16**

16FORFSX CAP

*Tompkins Industries, Inc.*

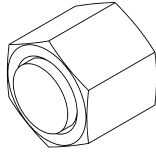

**FF0304-C-20**

20FORFSX CAP

*Tompkins Industries, Inc.*

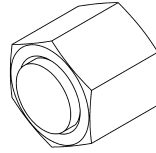

**FF0304-C-24**

24FORFSX CAP

*Tompkins Industries, Inc.*

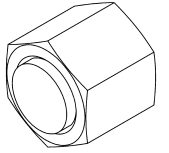

**FF0306-04**

04FORFS BULKHEAD NUT

*Tompkins Industries, Inc.*

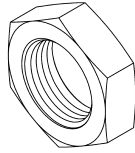

**FF0306-06**

06FORFS BULKHEAD NUT

*Tompkins Industries, Inc.*

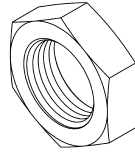

**FF0306-08**

08FORFS BULKHEAD NUT

*Tompkins Industries, Inc.*

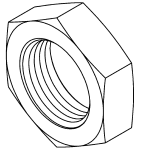

**FF0306-10**

10FORFS BULKHEAD NUT

*Tompkins Industries, Inc.*

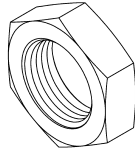

**FF0306-12**

12FORFS BULKHEAD NUT

*Tompkins Industries, Inc.*

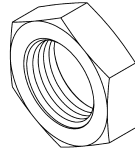

**FF0306-16**

16FORFS BULKHEAD NUT

*Tompkins Industries, Inc.*

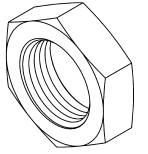

**FF0306-20**

20FORFS BULKHEAD NUT

*Tompkins Industries, Inc.*

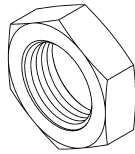

**FF0306-24**

24FORFS BULKHEAD NUT

*Tompkins Industries, Inc.*

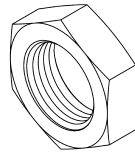

**FF0318-04**

04FORFS TUBE NUT

*Tompkins Industries, Inc.*

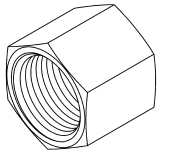

**FF0318-06**

06FORFS TUBE NUT

*Tompkins Industries, Inc.*

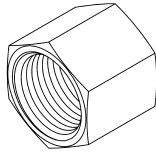

**FF0318-08**

08FORFS TUBE NUT

*Tompkins Industries, Inc.*

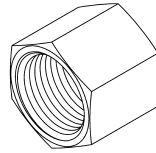

**FF0318-10**

10FORFS TUBE NUT

*Tompkins Industries, Inc.*

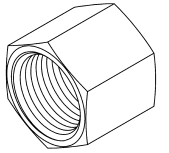

**FF0318-12**

12FORFS TUBE NUT

*Tompkins Industries, Inc.*

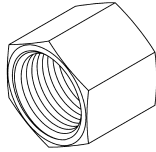

**FF0318-16**

16FORFS TUBE NUT

*Tompkins Industries, Inc.*

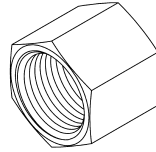

**FF0318-20**

20FORFS TUBE NUT

*Tompkins Industries, Inc.*

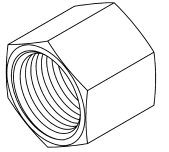

**FF0318-24**

24FORFS TUBE NUT

*Tompkins Industries, Inc.*

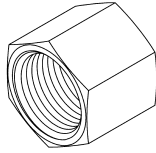

**FF0319-04**

04 BRAZE-ON TUBE SLEEVE

*Tompkins Industries, Inc.*

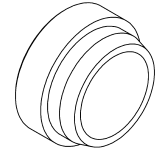

**FF0319-06**

06 BRAZE-ON TUBE SLEEVE

*Tompkins Industries, Inc.*

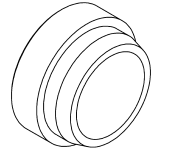

**FF0319-08**

08 BRAZE-ON TUBE SLEEVE

*Tompkins Industries, Inc.*

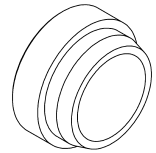

**FF0319-10**

10 BRAZE-ON TUBE SLEEVE

*Tompkins Industries, Inc.*

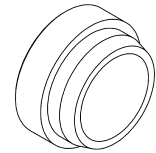

**FF0319-12**

12 BRAZE-ON TUBE SLEEVE

*Tompkins Industries, Inc.*

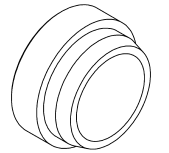

**FF0319-16**

16 BRAZE-ON TUBE SLEEVE

*Tompkins Industries, Inc.*

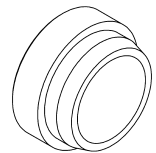

**FF0319-20**

20 BRAZE-ON TUBE SLEEVE

*Tompkins Industries, Inc.*

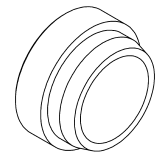

**FF0319-24**

24 BRAZE-ON TUBE SLEEVE

*Tompkins Industries, Inc.*

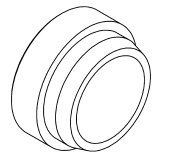

**FF0403-04-04**

04 BORE-04MORFS

*Tompkins Industries, Inc.*

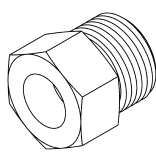

**FF0403-06-06**

06 BORE-06MORFS

*Tompkins Industries, Inc.*

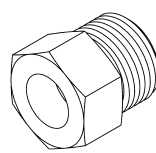

**FF0403-08-06**

08 BORE-06MORFS

*Tompkins Industries, Inc.*

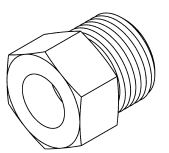

FF0403-08-08

08 BORE-08MORFS

*Tompkins Industries, Inc.*

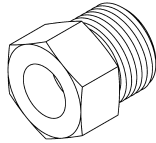

FF0403-12-08

12 BORE-08MORFS

*Tompkins Industries, Inc.*

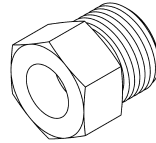

FF0403-12-12

12 BORE-12MORFS

*Tompkins Industries, Inc.*

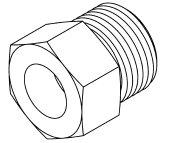

FF0403-16-12-1-1/4

16 BORE-12MORFS

*Tompkins Industries, Inc.*

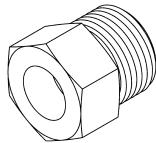

FF0403-16-16

16 BORE-16MORFS

*Tompkins Industries, Inc.*

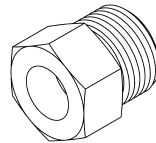

FF0403-20-16

20 BORE-16MORFS

*Tompkins Industries, Inc.*

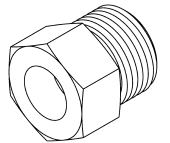

FF0403-20-20

20 BORE-20MORFS

*Tompkins Industries, Inc.*

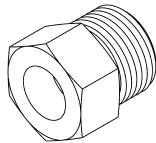

FF0403-24-20

24 BORE-20MORFS

*Tompkins Industries, Inc.*

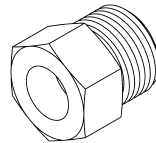

FF0403-24-24

24 BORE-24MORFS

*Tompkins Industries, Inc.*

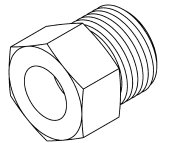

FF2402-04-04

04MORFS-04MJ

*Tompkins Industries, Inc.*

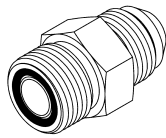

FF2402-06-06

06MORFS-06MJ

*Tompkins Industries, Inc.*

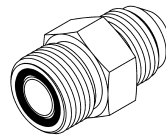

FF2402-08-08

08MORFS-08MJ

*Tompkins Industries, Inc.*

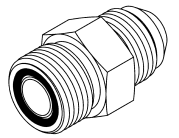

FF2402-10-10

10MORFS-10MJ

*Tompkins Industries, Inc.*

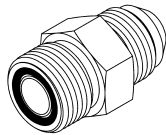

FF2402-12-12

12MORFS-12MJ

*Tompkins Industries, Inc.*

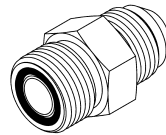

FF2402-16-16

16MORFS-16MJ

*Tompkins Industries, Inc.*

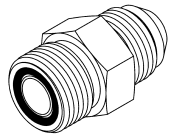

FF2402-20-20

20MORFS-20MJ

*Tompkins Industries, Inc.*

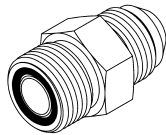

FF2403-04-04

04MORFS-04MORFS

*Tompkins Industries, Inc.*

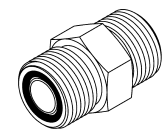

FF2403-06-04

06MORFS-04MORFS

*Tompkins Industries, Inc.*

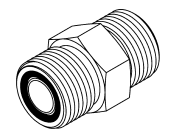

FF2403-06-06

06MORFS-06MORFS

*Tompkins Industries, Inc.*

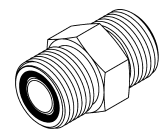

FF2403-08-06

08MORFS-06MORFS

*Tompkins Industries, Inc.*

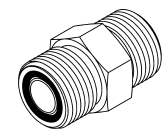

FF2403-08-08

08MORFS-08MORFS

*Tompkins Industries, Inc.*

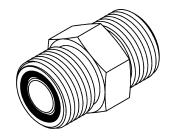

FF2403-10-08

10MORFS-08MORFS

*Tompkins Industries, Inc.*

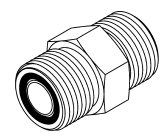

FF2403-10-10

10MORFS-10MORFS

*Tompkins Industries, Inc.*

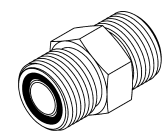

FF2403-12-08

12MORFS-08MORFS

*Tompkins Industries, Inc.*

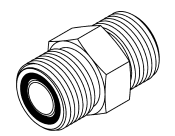

FF2403-12-10

12MORFS-10MORFS

*Tompkins Industries, Inc.*

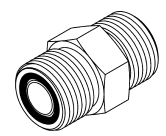

FF2403-12-12

12MORFS-12MORFS

*Tompkins Industries, Inc.*

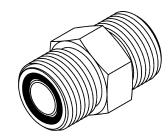

FF2403-16-12

16MORFS-12MORFS

*Tompkins Industries, Inc.*

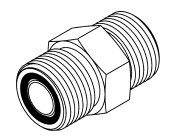

FF2403-16-16

16MORFS-16MORFS

*Tompkins Industries, Inc.*

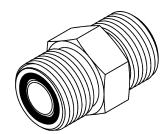

FF2403-20-16

20MORFS-16MORFS

*Tompkins Industries, Inc.*



FF2403-20-20

20MORFS-20MORFS

*Tompkins Industries, Inc.*



FF2403-24-20

24MORFS-20MORFS

*Tompkins Industries, Inc.*

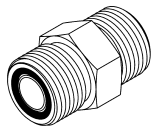

FF2403-24-24

24MORFS-24MORFS

*Tompkins Industries, Inc.*



FF2404-04-02

04MORFS-02MP

*Tompkins Industries, Inc.*



FF2404-04-04

04MORFS-04MP

*Tompkins Industries, Inc.*

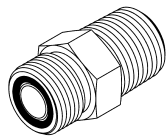

FF2404-04-06

04MORFS-06MP

*Tompkins Industries, Inc.*

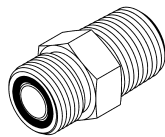

FF2404-04-08

04MORFS-08MP

*Tompkins Industries, Inc.*

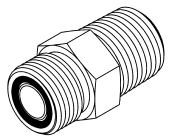

FF2404-06-02

06MORFS-02MP

*Tompkins Industries, Inc.*

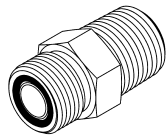

FF2404-06-04

06MORFS-04MP

*Tompkins Industries, Inc.*

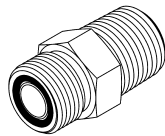

FF2404-06-06

06MORFS-06MP

*Tompkins Industries, Inc.*

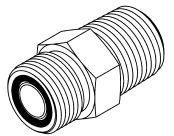

FF2404-06-08

06MORFS-08MP

*Tompkins Industries, Inc.*

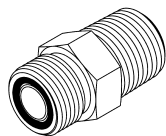

FF2404-08-04

08MORFS-04MP

*Tompkins Industries, Inc.*

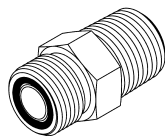

FF2404-08-06

08MORFS-06MP

*Tompkins Industries, Inc.*

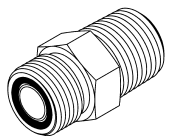

FF2404-08-08

08MORFS-08MP

*Tompkins Industries, Inc.*

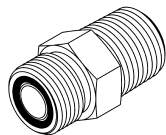

FF2404-08-12

08MORFS-12MP

*Tompkins Industries, Inc.*

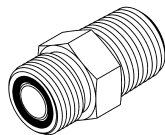

FF2404-08-16

08MORFS-16MP

*Tompkins Industries, Inc.*

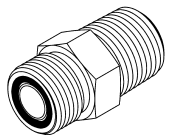

FF2404-10-08

10MORFS-08MP

*Tompkins Industries, Inc.*

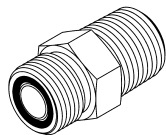

FF2404-10-12

10MORFS-12MP

*Tompkins Industries, Inc.*

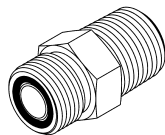

FF2404-10-16

10MORFS-16MP

*Tompkins Industries, Inc.*

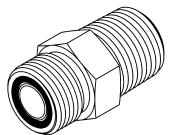

FF2404-12-08

12MORFS-08MP

*Tompkins Industries, Inc.*

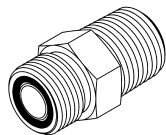

FF2404-12-12

12MORFS-12MP

*Tompkins Industries, Inc.*

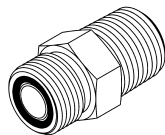

FF2404-12-16

12MORFS-16MP

*Tompkins Industries, Inc.*

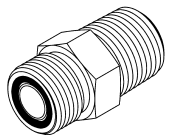

FF2404-16-12

16MORFS-12MP

*Tompkins Industries, Inc.*

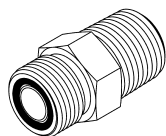

FF2404-16-16

16MORFS-16MP

*Tompkins Industries, Inc.*

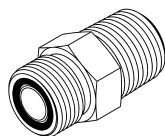

FF2404-16-20

16MORFS-20MP

*Tompkins Industries, Inc.*

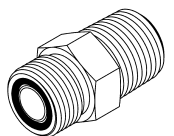

FF2404-16-24

16MORFS-24MP

*Tompkins Industries, Inc.*

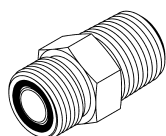

FF2404-20-16

20MORFS-16MP

*Tompkins Industries, Inc.*

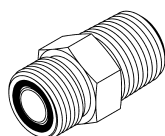

FF2404-20-20

20MORFS-20MP

*Tompkins Industries, Inc.*

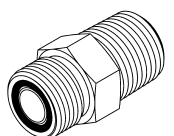

FF2404-24-24

24MORFS-24MP

*Tompkins Industries, Inc.*

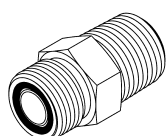

FF2405-04-04

04MORFS-04FP

*Tompkins Industries, Inc.*

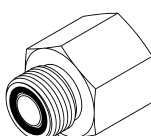

FF2405-06-06

06MORFS-06FP

*Tompkins Industries, Inc.*

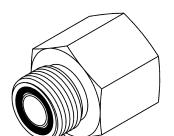

**FF2405-08-08**

08MORFS-08FP

*Tompkins Industries, Inc.*

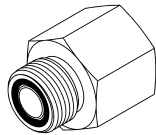

**FF2405-10-08**

10MORFS-08FP

*Tompkins Industries, Inc.*

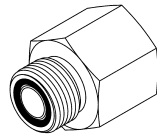

**FF2405-12-12**

12MORFS-12FP

*Tompkins Industries, Inc.*

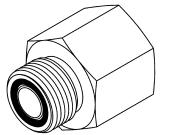

**FF2405-16-16**

16MORFS-16FP

*Tompkins Industries, Inc.*

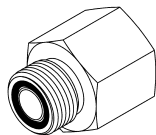

**FF2405-20-20**

20MORFS-20FP

*Tompkins Industries, Inc.*

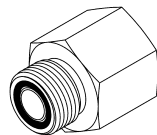

**FF2406-04-06**

04FORFSX-06MORFS

*Tompkins Industries, Inc.*

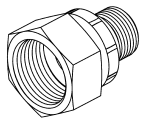

**FF2406-06-04**

06FORFSX-04MORFS

*Tompkins Industries, Inc.*

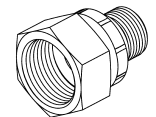

**FF2406-06-08**

06FORFSX-08MORFS

*Tompkins Industries, Inc.*

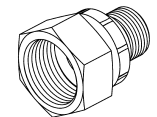

**FF2406-08-04**

08FORFSX-04MORFS

*Tompkins Industries, Inc.*

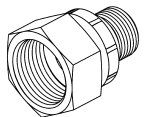

**FF2406-08-06**

08FORFSX-06MORFS

*Tompkins Industries, Inc.*

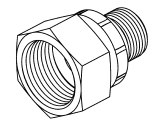

**FF2406-08-08**

08FORFSX-08MORFS

*Tompkins Industries, Inc.*

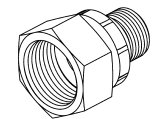

**FF2406-08-10**

08FORFSX-10MORFS

*Tompkins Industries, Inc.*

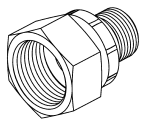

**FF2406-08-12**

08FORFSX-12MORFS

*Tompkins Industries, Inc.*

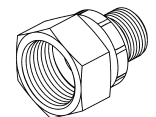

**FF2406-10-06**

10FORFSX-06MORFS

*Tompkins Industries, Inc.*

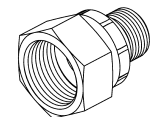

**FF2406-10-08**

10FORFSX-08MORFS

*Tompkins Industries, Inc.*

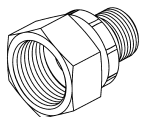

**FF2406-10-12**

10FORFSX-12MORFS

*Tompkins Industries, Inc.*

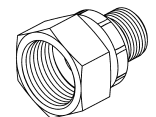

**FF2406-12-04**

12FORFSX-04MORFS

*Tompkins Industries, Inc.*

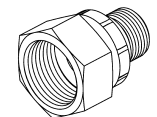

**FF2406-12-06**

12FORFSX-06MORFS

*Tompkins Industries, Inc.*

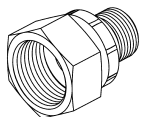

**FF2406-12-08**

12FORFSX-08MORFS

*Tompkins Industries, Inc.*

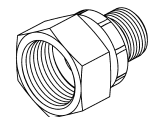

**FF2406-12-10**

12FORFSX-10MORFS

*Tompkins Industries, Inc.*

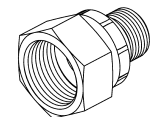

**FF2406-12-16**

12FORFSX-16MORFS

*Tompkins Industries, Inc.*

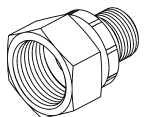

**FF2406-16-08**

16FORFSX-08MORFS

*Tompkins Industries, Inc.*

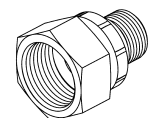

**FF2406-16-12**

16FORFSX-12MORFS

*Tompkins Industries, Inc.*

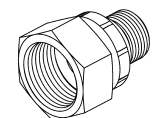

**FF2406-16-20**

16FORFSX-20MORFS

*Tompkins Industries, Inc.*

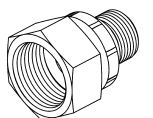

**FF2406-20-12**

20FORFSX-12MORFS

*Tompkins Industries, Inc.*

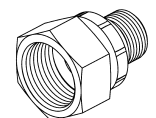

**FF2406-20-16**

20FORFSX-16MORFS

*Tompkins Industries, Inc.*

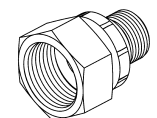

**FF2406-20-24**

20FORFSX-24MORFS

*Tompkins Industries, Inc.*

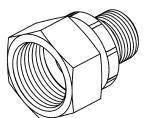

**FF2406-24-20**

24FORFSX-20MORFS

*Tompkins Industries, Inc.*

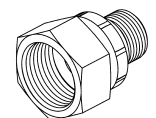

**FF2408-04**

04MORFS HEX HEAD PLUG

*Tompkins Industries, Inc.*

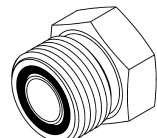

**FF2408-06**

06MORFS HEX HEAD PLUG

*Tompkins Industries, Inc.*

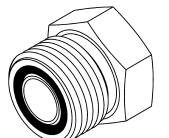

**FF2408-08**

08MORFS HEX HEAD PLUG

*Tompkins Industries, Inc.*

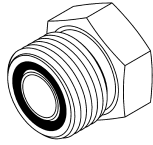

**FF2408-10**

10MORFS HEX HEAD PLUG

*Tompkins Industries, Inc.*

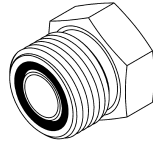

**FF2408-12**

12MORFS HEX HEAD PLUG

*Tompkins Industries, Inc.*

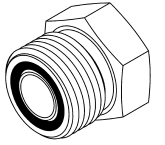

**FF2408-16**

16MORFS HEX HEAD PLUG

*Tompkins Industries, Inc.*

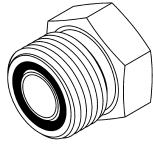

**FF2408-20**

20MORFS HEX HEAD PLUG

*Tompkins Industries, Inc.*

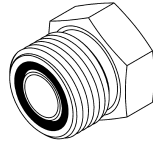

**FF2408-24**

24MORFS HEX HEAD PLUG

*Tompkins Industries, Inc.*

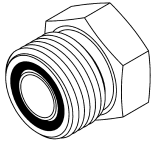

**FF2500-04-04**

04MORFS-04MORFS 90

*Tompkins Industries, Inc.*



**FF2500-06-04**

06MORFS-04MORFS 90

*Tompkins Industries, Inc.*



**FF2500-06-06**

06MORFS-06MORFS 90

*Tompkins Industries, Inc.*

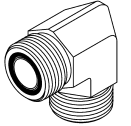

**FF2500-08-08**

08MORFS-08MORFS 90

*Tompkins Industries, Inc.*



**FF2500-10-10**

10MORFS-10MORFS 90

*Tompkins Industries, Inc.*

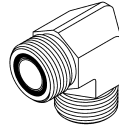

**FF2500-12-08**

12MORFS-08MORFS 90

*Tompkins Industries, Inc.*

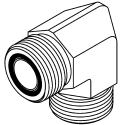

**FF2500-12-12**

12MORFS-12MORFS 90

*Tompkins Industries, Inc.*

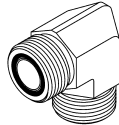

**FF2500-16-12**

16MORFS-12MORFS 90

*Tompkins Industries, Inc.*

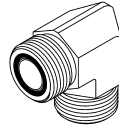

**FF2500-16-16**

16MORFS-16MORFS 90

*Tompkins Industries, Inc.*

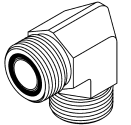

**FF2500-20-16**

20MORFS-16MORFS 90

*Tompkins Industries, Inc.*

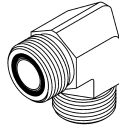

**FF2500-20-20**

20MORFS-20MORFS 90

*Tompkins Industries, Inc.*

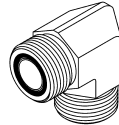

**FF2500-24-24**

24MORFS-24MORFS 90

*Tompkins Industries, Inc.*

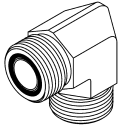

**FF2501-04-02**

04MORFS-02MP 90

*Tompkins Industries, Inc.*

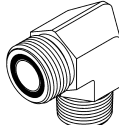

**FF2501-04-04**

04MORFS-04MP 90

*Tompkins Industries, Inc.*

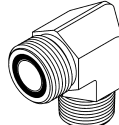

**FF2501-04-06**

04MORFS-06MP 90

*Tompkins Industries, Inc.*

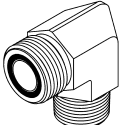

**FF2501-04-08**

04MORFS-08MP 90

*Tompkins Industries, Inc.*

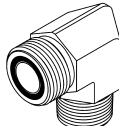

**FF2501-06-04**

06MORFS-04MP 90

*Tompkins Industries, Inc.*

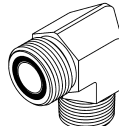

**FF2501-06-06**

06MORFS-06MP 90

*Tompkins Industries, Inc.*

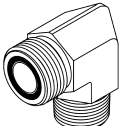

**FF2501-06-08**

06MORFS-08MP 90

*Tompkins Industries, Inc.*

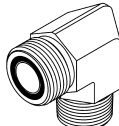

**FF2501-08-04**

08MORFS-04MP 90

*Tompkins Industries, Inc.*

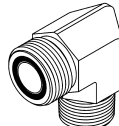

**FF2501-08-06**

08MORFS-06MP 90

*Tompkins Industries, Inc.*

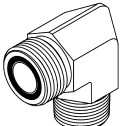

**FF2501-08-08**

08MORFS-08MP 90

*Tompkins Industries, Inc.*

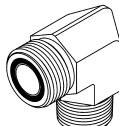

**FF2501-08-12**

08MORFS-12MP 90

*Tompkins Industries, Inc.*

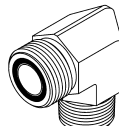

**FF2501-10-08**

10MORFS-08MP 90

*Tompkins Industries, Inc.*

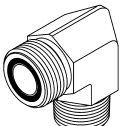

FF2501-10-12

10MORFS-12MP 90

*Tompkins Industries, Inc.*

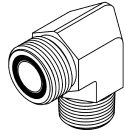

FF2501-10-16

10MORFS-16MP 90

*Tompkins Industries, Inc.*

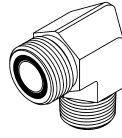

FF2501-12-08

12MORFS-08MP 90

*Tompkins Industries, Inc.*

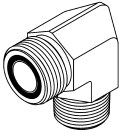

FF2501-12-12

12MORFS-12MP 90

*Tompkins Industries, Inc.*

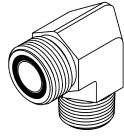

FF2501-12-16

12MORFS-16MP 90

*Tompkins Industries, Inc.*

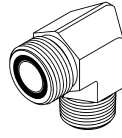

FF2501-16-12

16MORFS-12MP 90

*Tompkins Industries, Inc.*

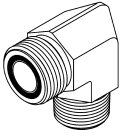

FF2501-16-16

16MORFS-16MP 90

*Tompkins Industries, Inc.*

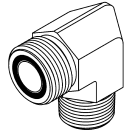

FF2501-20-16

20MORFS-16MP 90

*Tompkins Industries, Inc.*

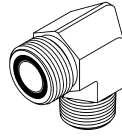

FF2501-20-20

20MORFS-20MP 90

*Tompkins Industries, Inc.*

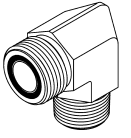

FF2501-24-24

24MORFS-24MP 90

*Tompkins Industries, Inc.*



FF2503-04-02

04MORFS-02MP 45

*Tompkins Industries, Inc.*

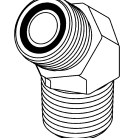

FF2503-04-04

04MORFS-04MP 45

*Tompkins Industries, Inc.*

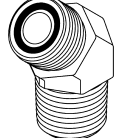

FF2503-06-04

06MORFS-04MP 45

*Tompkins Industries, Inc.*

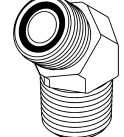

FF2503-06-06

06MORFS-06MP 45

*Tompkins Industries, Inc.*

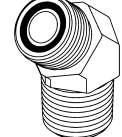

FF2503-08-06

08MORFS-06MP 45

*Tompkins Industries, Inc.*

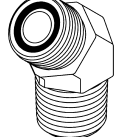

FF2503-08-08

08MORFS-08MP 45

*Tompkins Industries, Inc.*

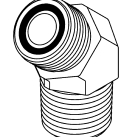

FF2503-10-08

10MORFS-08MP 45

*Tompkins Industries, Inc.*

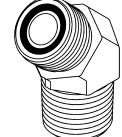

FF2503-12-12

12MORFS-12MP 45

*Tompkins Industries, Inc.*

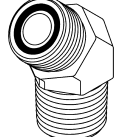

FF2503-16-12

16MORFS-12MP 45

*Tompkins Industries, Inc.*

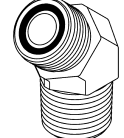

FF2503-16-16

16MORFS-16MP 45

*Tompkins Industries, Inc.*

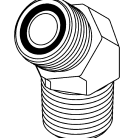

FF2503-20-16

20MORFS-16MP 45

*Tompkins Industries, Inc.*

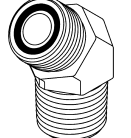

FF2503-20-20

20MORFS-20MP 45

*Tompkins Industries, Inc.*

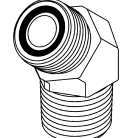

FF2503-24-24

24MORFS-24MP 45

*Tompkins Industries, Inc.*

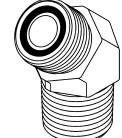

FF2601-04-04-04

04MORFS-04MORFS-04MP TEE

*Tompkins Industries, Inc.*

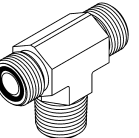

FF2601-06-06-04

06MORFS-06MORFS-04MP TEE

*Tompkins Industries, Inc.*

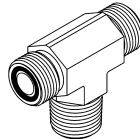

FF2601-06-06-06

06MORFS-06MORFS-06MP TEE

*Tompkins Industries, Inc.*

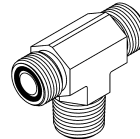

FF2601-08-08-06

08MORFS-08MORFS-06MP TEE

*Tompkins Industries, Inc.*

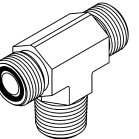

FF2601-08-08-08

08MORFS-08MORFS-08MP TEE

*Tompkins Industries, Inc.*

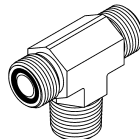

FF2601-10-10-08

10MORFS-10MORFS-08MP TEE

*Tompkins Industries, Inc.*

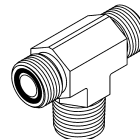

FF2601-12-12-12

12MORFS-12MORFS-12MP TEE

*Tompkins Industries, Inc.*

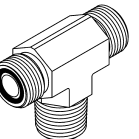

FF2601-16-16-16

16MORFS-16MORFS-16MP TEE

*Tompkins Industries, Inc.*

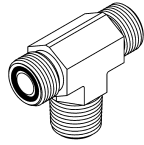

FF2601-20-20-20

20MORFS-20MORFS-20MP TEE

*Tompkins Industries, Inc.*

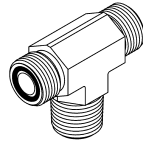

FF2603-04-04-04

04MORFS-04MORFS-04MORFS TEE

*Tompkins Industries, Inc.*

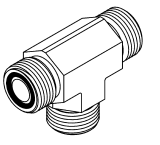

FF2603-06-06-06

06MORFS-06MORFS-06MORFS TEE

*Tompkins Industries, Inc.*

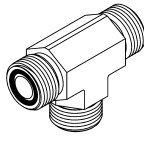

FF2603-06-06-08

06MORFS-05MORFS-08MORFS TEE

*Tompkins Industries, Inc.*

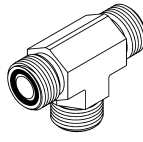

FF2603-08-08-08

08MORFS-08MORFS-08MORFS TEE

*Tompkins Industries, Inc.*

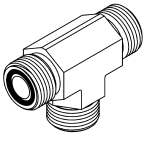

FF2603-10-10-10

10MORFS-10MORFS-10MORFS TEE

*Tompkins Industries, Inc.*

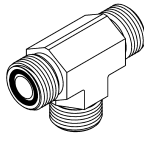

FF2603-12-12-12

12MORFS-12MORFS-12MORFS TEE

*Tompkins Industries, Inc.*

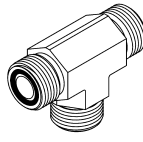

FF2603-16-16-16

16MORFS-16MORFS-16MORFS TEE

*Tompkins Industries, Inc.*

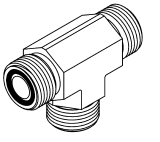

FF2603-20-20-20

20MORFS-20MORFS-20MORFS TEE

*Tompkins Industries, Inc.*

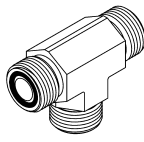

FF2603-24-24-24

24MORFS-24MORFS-24MORFS TEE

*Tompkins Industries, Inc.*

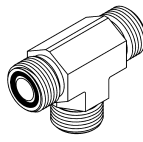

FF2605-04-04-04

04MORFS-04MP-04MORFS TEE

*Tompkins Industries, Inc.*

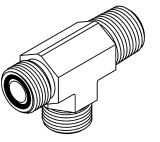

FF2605-06-04-06

06MORFS-04MP-06MORFS TEE

*Tompkins Industries, Inc.*

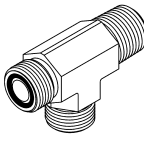

FF2605-06-06-06

06MORFS-06MP-06MORFS TEE

*Tompkins Industries, Inc.*

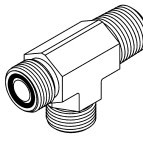

FF2605-08-08-08

08MORFS-08MP-08MORFS TEE

*Tompkins Industries, Inc.*

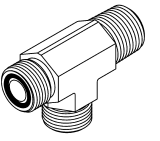

FF2650-04-04-04-04

04MORFS UNION CROSS

*Tompkins Industries, Inc.*

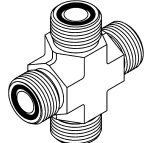

FF2650-06-06-06-06

06MORFS UNION CROSS

*Tompkins Industries, Inc.*

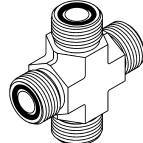

FF2650-08-08-08-08

08MORFS UNION CROSS

*Tompkins Industries, Inc.*

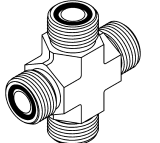

FF2650-10-10-10-10

10MORFS UNION CROSS

*Tompkins Industries, Inc.*

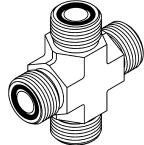

FF2650-12-12-12-12

12MORFS UNION CROSS

*Tompkins Industries, Inc.*

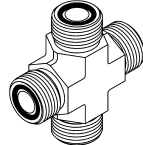

FF2650-16-16-16-16

16MORFS UNION CROSS

*Tompkins Industries, Inc.*

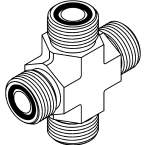

FF2650-20-20-20-20

20MORFS UNION CROSS

*Tompkins Industries, Inc.*

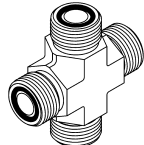

FF2650-24-24-24-24

24MORFS UNION CROSS

*Tompkins Industries, Inc.*

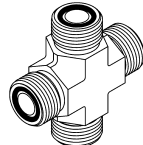

FF2700-04-04

04MORFS BULKHEAD UNION

*Tompkins Industries, Inc.*

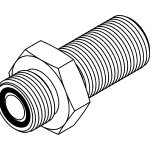

FF2700-06-06

06MORFS BULKHEAD UNION

*Tompkins Industries, Inc.*

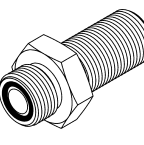

FF2700-08-08

08MORFS BULKHEAD UNION

*Tompkins Industries, Inc.*

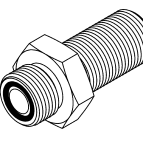

FF2700-10-10

10MORFS BULKHEAD UNION

*Tompkins Industries, Inc.*

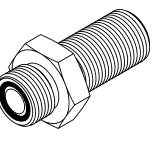

FF2700-12-12

12MORFS BULKHEAD UNION

*Tompkins Industries, Inc.*

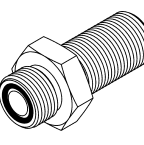

FF2700-16-16

16MORFS BULKHEAD UNION

*Tompkins Industries, Inc.*

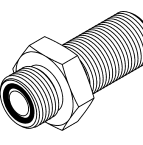

FF2700-20-20

20MORFS BULKHEAD UNION

*Tompkins Industries, Inc.*

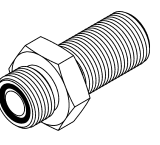

**FF2700-24-24**

24MORFS BULKHEAD UNION

*Tompkins Industries, Inc.*

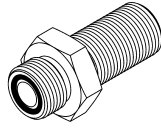

**FF2700-LN-04-04**

04MORFS BULKHEAD UNION  
W/LN

*Tompkins Industries, Inc.*

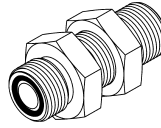

**FF2700-LN-06-06**

06MORFS BULKHEAD UNION  
W/LN

*Tompkins Industries, Inc.*

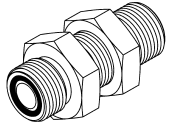

**FF2700-LN-08-08**

08MORFS BULKHEAD UNION  
W/LN

*Tompkins Industries, Inc.*

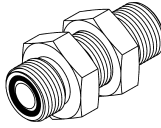

**FF2700-LN-10-10**

10MORFS BULKHEAD UNION  
W/LN

*Tompkins Industries, Inc.*

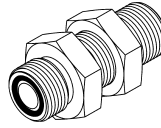

**FF2700-LN-12-12**

12MORFS BULKHEAD UNION  
W/LN

*Tompkins Industries, Inc.*

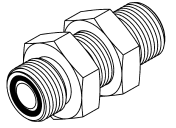

**FF2700-LN-16-16**

16MORFS BULKHEAD UNION  
W/LN

*Tompkins Industries, Inc.*

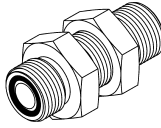

**FF2700-LN-20-20**

20MORFS BULKHEAD UNION  
W/LN

*Tompkins Industries, Inc.*

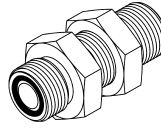

**FF2700-LN-24-24**

24MORFS BULKHEAD UNION  
W/LN

*Tompkins Industries, Inc.*

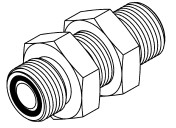

**FF2701-04-04**

04MORFS BULKHEAD UNION 90

*Tompkins Industries, Inc.*

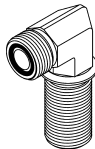

**FF2701-06-06**

06MORFS BULKHEAD UNION 90

*Tompkins Industries, Inc.*

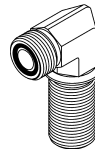

**FF2701-08-08**

08MORFS BULKHEAD UNION 90

*Tompkins Industries, Inc.*

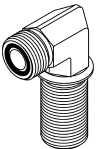

**FF2701-10-10**

10MORFS BULKHEAD UNION 90

*Tompkins Industries, Inc.*

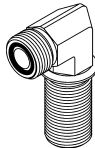

**FF2701-12-12**

12MORFS BULKHEAD UNION 90

*Tompkins Industries, Inc.*

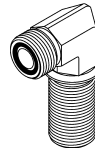

**FF2701-16-16**

16MORFS BULKHEAD UNION 90

*Tompkins Industries, Inc.*

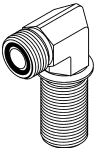

**FF2701-20-20**

20MORFS BULKHEAD UNION 90

*Tompkins Industries, Inc.*

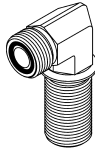

**FF2701-24-24**

24MORFS BULKHEAD UNION 90

*Tompkins Industries, Inc.*

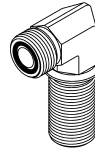

**FF2701-LN-04-04**

04MORFS BULKHEAD UNION 90  
W/LN

*Tompkins Industries, Inc.*

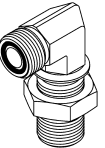

**FF2701-LN-06-06**

06MORFS BULKHEAD UNION 90  
W/LN

*Tompkins Industries, Inc.*

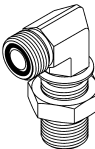

**FF2701-LN-08-08**

08MORFS BULKHEAD UNION 90  
W/LN

*Tompkins Industries, Inc.*

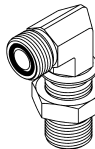

**FF2701-LN-10-10**

10MORFS BULKHEAD UNION 90  
W/LN

*Tompkins Industries, Inc.*

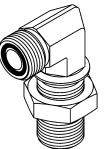

**FF2701-LN-12-12**

12MORFS BULKHEAD UNION 90  
W/LN

*Tompkins Industries, Inc.*

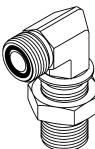

**FF2701-LN-16-16**

16MORFS BULKHEAD UNION 90  
W/LN

*Tompkins Industries, Inc.*

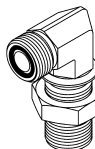

**FF2701-LN-20-20**

20MORFS BULKHEAD UNION 90  
W/LN

*Tompkins Industries, Inc.*

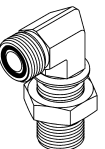

**FF2701-LN-24-24**

24MORFS BULKHEAD UNION 90  
W/LN

*Tompkins Industries, Inc.*

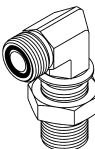

**FF2702-04-04**

04MORFS BULKHEAD UNION 45

*Tompkins Industries, Inc.*

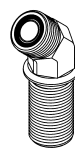

**FF2702-06-06**

06MORFS BULKHEAD UNION 45

*Tompkins Industries, Inc.*

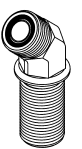

**FF2702-08-08**

08MORFS BULKHEAD UNION 45

*Tompkins Industries, Inc.*

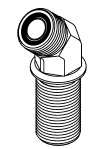

**FF2702-10-10**

10MORFS BULKHEAD UNION 45

*Tompkins Industries, Inc.*

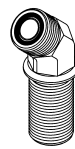

**FF2702-12-12**

12MORFS BULKHEAD UNION 45

*Tompkins Industries, Inc.*

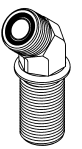

# FF2702-16-16

16MORFS BULKHEAD UNION 45

*Tompkins Industries, Inc.*

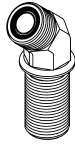

# FF2702-20-20

20MORFS BULKHEAD UNION 45

*Tompkins Industries, Inc.*



# FF2702-24-24

24MORFS BULKHEAD UNION 45

*Tompkins Industries, Inc.*

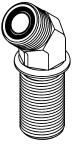

# FF2702-LN-04-04

04MORFS BULKHEAD UNION 45  
W/LN

*Tompkins Industries, Inc.*

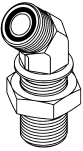

# FF2702-LN-06-06

06MORFS BULKHEAD UNION 45  
W/LN

*Tompkins Industries, Inc.*

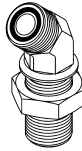

# FF2702-LN-08-08

08MORFS BULKHEAD UNION 45  
W/LN

*Tompkins Industries, Inc.*

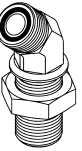

# FF2702-LN-10-10

10MORFS BULKHEAD UNION 45  
W/LN

*Tompkins Industries, Inc.*

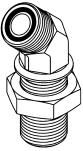

# FF2702-LN-12-12

12MORFS BULKHEAD UNION 45  
W/LN

*Tompkins Industries, Inc.*

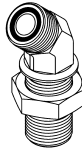

# FF2702-LN-16-16

16MORFS BULKHEAD UNION 45  
W/LN

*Tompkins Industries, Inc.*

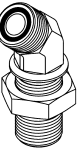

# FF2702-LN-20-20

20MORFS BULKHEAD UNION 45  
W/LN

*Tompkins Industries, Inc.*

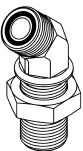

# FF2702-LN-24-24

24MORFS BULKHEAD UNION 45  
W/LN

*Tompkins Industries, Inc.*



# FF2703-04-04-04

04MORFS BLKD UNION TEE

*Tompkins Industries, Inc.*

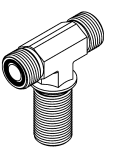

# FF2703-06-06-06

06MORFS BLKD UNION TEE

*Tompkins Industries, Inc.*

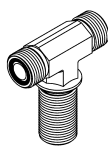

# FF2703-08-08-08

08MORFS BLKD UNION TEE

*Tompkins Industries, Inc.*

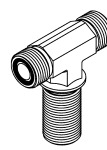

# FF2703-10-10-10

10MORFS BLKD UNION TEE

*Tompkins Industries, Inc.*

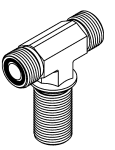

# FF2703-12-12-12

12MORFS BLKD UNION TEE

*Tompkins Industries, Inc.*

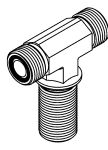

# FF2703-16-16-16

16MORFS BLKD UNION TEE

*Tompkins Industries, Inc.*

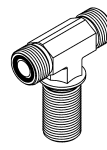

# FF2703-20-20-20

20MORFS BLKD UNION TEE

*Tompkins Industries, Inc.*

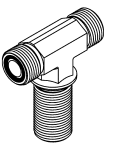

# FF2703-24-24-24

24MORFS BLKD UNION TEE

*Tompkins Industries, Inc.*

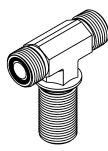

# FF2703-LN-04-04-04

04MORFS BLKD UNION TEE W/LN

*Tompkins Industries, Inc.*

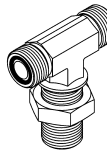

# FF2703-LN-06-06-06

06MORFS BLKD UNION TEE W/LN

*Tompkins Industries, Inc.*

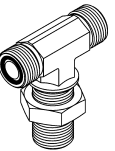

# FF2703-LN-08-08-08

08MORFS BLKD UNION TEE W/LN

*Tompkins Industries, Inc.*

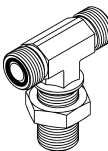

# FF2703-LN-10-10-10

10MORFS BLKD UNION TEE W/LN

*Tompkins Industries, Inc.*

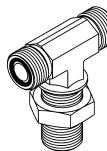

# FF2703-LN-12-12-12

12MORFS BLKD UNION TEE W/LN

*Tompkins Industries, Inc.*

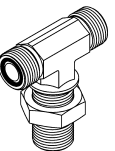

# FF2703-LN-16-16-16

16MORFS BLKD UNION TEE W/LN

*Tompkins Industries, Inc.*

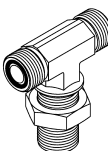

# FF2703-LN-20-20-20

20MORFS BLKD UNION TEE W/LN

*Tompkins Industries, Inc.*

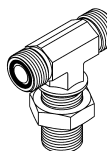

# FF2703-LN-24-24-24

24MORFS BLKD UNION TEE W/LN

*Tompkins Industries, Inc.*

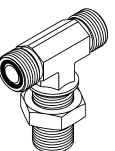

# FF2704-04-04-04

04MORFS BULKHEAD UNION RUN  
TEE

*Tompkins Industries, Inc.*

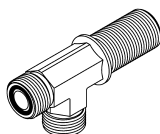

# FF2704-06-06-06

06MORFS BULKHEAD UNION RUN  
TEE

*Tompkins Industries, Inc.*

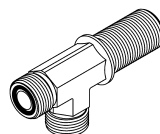

# FF2704-08-08-08

08MORFS BULKHEAD UNION RUN  
TEE

*Tompkins Industries, Inc.*

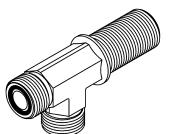

**FF2704-10-10-10**

10MORFS BULKHEAD UNION RUN TEE

*Tompkins Industries, Inc.*

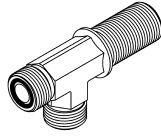

**FF2704-20-20-20**

20MORFS BULKHEAD UNION RUN TEE

*Tompkins Industries, Inc.*

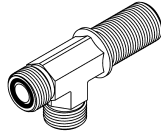

**FF2704-LN-06-06-06**

06MORFS BLKD UNION RUN TEE W/LN

*Tompkins Industries, Inc.*

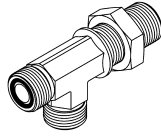

**FF2704-LN-12-12-12**

12MORFS BLKD UNION RUN TEE W/LN

*Tompkins Industries, Inc.*

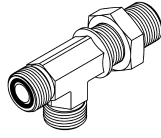

**FF2704-LN-24-24-24**

24MORFS BLKD UNION RUN TEE W/LN

*Tompkins Industries, Inc.*

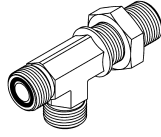

**FF2706-06-04**

06MORFS-04MP BULKHEAD

*Tompkins Industries, Inc.*

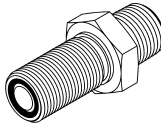

**FF2709-04-06**

04MORFS-06MB BULKHEAD

*Tompkins Industries, Inc.*

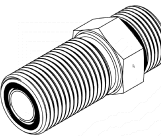

**FF2709-10-10**

10MORFS-10MB BULKHEAD

*Tompkins Industries, Inc.*

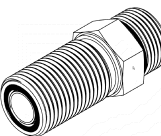

**FF2709-20-20**

20MORFS-20MB BULKHEAD

*Tompkins Industries, Inc.*

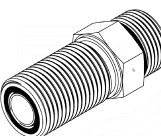

**FF2709-LN-04-06**

04MORFS-06MB BULKHEAD W/LN

*Tompkins Industries, Inc.*

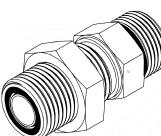

**FF2704-12-12-12**

12MORFS BULKHEAD UNION RUN TEE

*Tompkins Industries, Inc.*

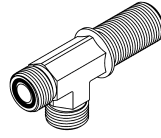

**FF2704-24-24-24**

24MORFS BULKHEAD UNION RUN TEE

*Tompkins Industries, Inc.*

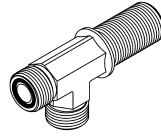

**FF2704-LN-08-08-08**

08MORFS BLKD UNION RUN TEE W/LN

*Tompkins Industries, Inc.*

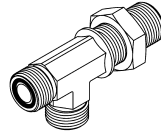

**FF2704-LN-16-16-16**

16MORFS BLKD UNION RUN TEE W/LN

*Tompkins Industries, Inc.*

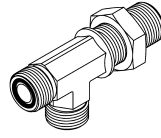

**FF2705-06-04**

06MORFS-04FP BULKHEAD

*Tompkins Industries, Inc.*

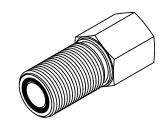

**FF2706-LN-06-04**

06MORFS-04MP BULKHEAD W/LN

*Tompkins Industries, Inc.*

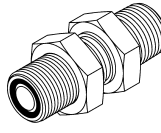

**FF2709-06-06**

06MORFS-06MB BULKHEAD

*Tompkins Industries, Inc.*

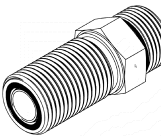

**FF2709-12-12**

12MORFS-12MB BULKHEAD

*Tompkins Industries, Inc.*

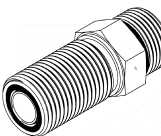

**FF2709-24-24**

24MORFS-24MB BULKHEAD

*Tompkins Industries, Inc.*

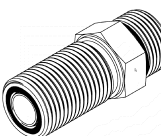

**FF2709-LN-06-06**

06MORFS-06MORB BULKHEAD W/LN

*Tompkins Industries, Inc.*

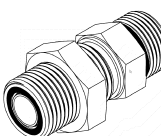

**FF2704-16-16-16**

16MORFS BULKHEAD UNION RUN TEE

*Tompkins Industries, Inc.*

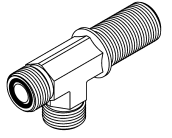

**FF2704-LN-04-04-04**

04MORFS BLKD UNION RUN TEE W/LN

*Tompkins Industries, Inc.*

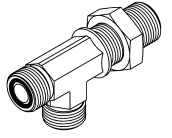

**FF2704-LN-10-10-10**

10MORFS BLKD UNION RUN TEE W/LN

*Tompkins Industries, Inc.*

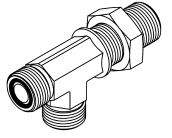

**FF2704-LN-20-20-20**

20MORFS BLKD UNION RUN TEE W/LN

*Tompkins Industries, Inc.*

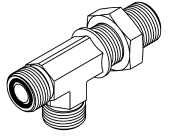

**FF2705-LN-06-04**

06MORFS-04FP BULKHEAD W/LN

*Tompkins Industries, Inc.*

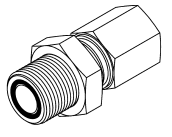

**FF2709-04-04**

04MORFS-04MB BULKHEAD

*Tompkins Industries, Inc.*



**FF2709-08-08**

08MORFS-08MB BULKHEAD

*Tompkins Industries, Inc.*

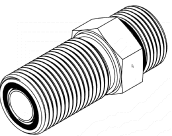

**FF2709-16-16**

16MORFS-16MB BULKHEAD

*Tompkins Industries, Inc.*

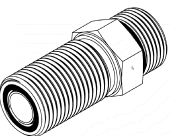

**FF2709-LN-04-04**

04MORFS-04MB BULKHEAD W/LN

*Tompkins Industries, Inc.*

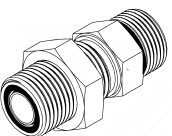

**FF2709-LN-08-08**

08MORFS-08MORB BULKHEAD W/LN

*Tompkins Industries, Inc.*

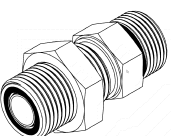

FF2709-LN-10-10

10MORFS-10MORB BULKHEAD  
W/LN

*Tompkins Industries, Inc.*



FF2709-LN-12-12

12MORFS-12MORB BULKHEAD  
W/LN

*Tompkins Industries, Inc.*

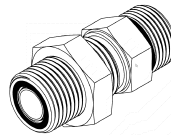

FF2709-LN-16-16

16MORFS-16MB BULKHEAD  
W/LN

*Tompkins Industries, Inc.*

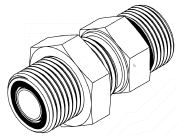

FF2709-LN-20-20

20MORFS-20MB BULKHEAD  
W/LN

*Tompkins Industries, Inc.*



FF2709-LN-24-24

24MORFS-24MB BULKHEAD  
W/LN

*Tompkins Industries, Inc.*

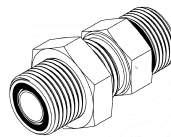

FF6400-04-04

04MORFS-04MOR

*Tompkins Industries, Inc.*

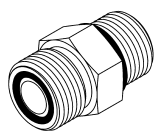

FF6400-04-05

04MORFS-05MOR

*Tompkins Industries, Inc.*



FF6400-04-06

04MORFS-06MOR

*Tompkins Industries, Inc.*



FF6400-04-08

04MORFS-08MOR

*Tompkins Industries, Inc.*



FF6400-06-04

06MORFS-04MOR

*Tompkins Industries, Inc.*



FF6400-06-05

06MORFS-05MOR

*Tompkins Industries, Inc.*



FF6400-06-06

06MORFS-06MOR

*Tompkins Industries, Inc.*



FF6400-06-08

06MORFS-08MOR

*Tompkins Industries, Inc.*



FF6400-06-10

06MORFS-10MOR

*Tompkins Industries, Inc.*



FF6400-06-12

06MORFS-12MOR

*Tompkins Industries, Inc.*



FF6400-06-16

06MORFS-16MOR

*Tompkins Industries, Inc.*



FF6400-08-06

08MORFS-06MOR

*Tompkins Industries, Inc.*



FF6400-08-08

08MORFS-08MOR

*Tompkins Industries, Inc.*



FF6400-08-10

08MORFS-10MOR

*Tompkins Industries, Inc.*



FF6400-08-12

08MORFS-12MOR

*Tompkins Industries, Inc.*



FF6400-08-16

08MORFS-16MOR

*Tompkins Industries, Inc.*



FF6400-10-06

10MORFS-06MOR

*Tompkins Industries, Inc.*



FF6400-10-08

10MORFS-08MOR

*Tompkins Industries, Inc.*



FF6400-10-10

10MORFS-10MOR

*Tompkins Industries, Inc.*



FF6400-10-12

10MORFS-12MOR

*Tompkins Industries, Inc.*



FF6400-12-08

12MORFS-08MOR

*Tompkins Industries, Inc.*



FF6400-12-10

12MORFS-10MOR

*Tompkins Industries, Inc.*



FF6400-12-12

12MORFS-12MOR

*Tompkins Industries, Inc.*



FF6400-12-16

12MORFS-16MOR

*Tompkins Industries, Inc.*



FF6400-12-20

12MORFS-20MOR

*Tompkins Industries, Inc.*



FF6400-16-10

16MORFS-10MOR

*Tompkins Industries, Inc.*



FF6400-16-12

16MORFS-12MOR

*Tompkins Industries, Inc.*



FF6400-16-16

16MORFS-16MOR

*Tompkins Industries, Inc.*



FF6400-16-20

16MORFS-20MOR

*Tompkins Industries, Inc.*



FF6400-16-24

16MORFS-24MOR

*Tompkins Industries, Inc.*



FF6400-20-16

20MORFS-16MOR

*Tompkins Industries, Inc.*



FF6400-20-20

20MORFS-20MOR

*Tompkins Industries, Inc.*



FF6400-20-24

20MORFS-24MOR

*Tompkins Industries, Inc.*



FF6400-24-24

24MORFS-24MOR

*Tompkins Industries, Inc.*

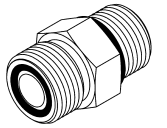

FF6400-L-04-04

04MORFS-04MOR LONG 2.07"

*Tompkins Industries, Inc.*

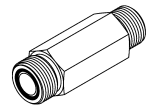

FF6400-L-06-06

06MORFS-06MOR LONG 2.27"

*Tompkins Industries, Inc.*

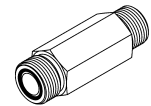

FF6400-L-06-08

06MORFS-08MOR LONG 2.14"

*Tompkins Industries, Inc.*

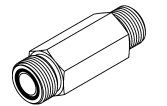

FF6400-L-08-08

08MORFS-08MOR LONG 2.67"

*Tompkins Industries, Inc.*

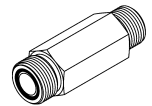

FF6400-L-10-08

10MORFS-08MOR LONG 3.23"

*Tompkins Industries, Inc.*

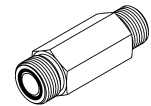

FF6400-L-10-10

10MORFS-10MOR LONG 3.13"

*Tompkins Industries, Inc.*

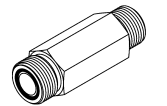

FF6400-L-12-12

12MORFS-12MOR LONG 3.76"

*Tompkins Industries, Inc.*

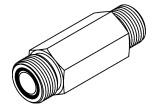

FF6400-L-16-16

16MORFS-16MOR LONG 4.14"

*Tompkins Industries, Inc.*

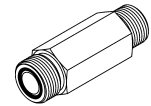

FF6400-L-20-16

20MORFS-16MOR LONG

*Tompkins Industries, Inc.*

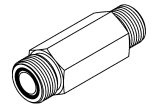

FF6400-L-20-20

20MORFS-20MOR LONG 4.76"

*Tompkins Industries, Inc.*

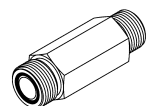

FF6402-04-04

04MORFS-04FJX

*Tompkins Industries, Inc.*

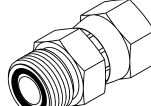

FF6402-06-06

06MORFS-06FJX

*Tompkins Industries, Inc.*

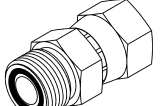

FF6402-08-08

08MORFS-08FJX

*Tompkins Industries, Inc.*

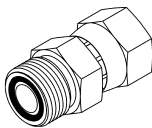

FF6402-10-10

10MORFS-10FJX

*Tompkins Industries, Inc.*

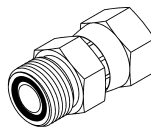

FF6402-12-12

12MORFS-12FJX

*Tompkins Industries, Inc.*

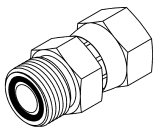

FF6402-16-16

16MORFS-16FJX

*Tompkins Industries, Inc.*

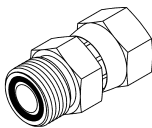

FF6402-20-20

20MORFS-20FJX

*Tompkins Industries, Inc.*

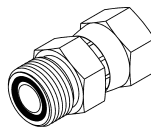

FF6402-24-24

24MORFS-24FJX

*Tompkins Industries, Inc.*

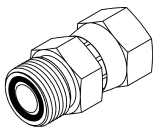

FF6500-04-04

04MORFS-04FORFSX 90

*Tompkins Industries, Inc.*



FF6500-04-06

04MORFS-06FORFSX 90

*Tompkins Industries, Inc.*



FF6500-06-06

06MORFS-06FORFSX 90

*Tompkins Industries, Inc.*



FF6500-08-06

08MORFS-06FORFSX 90

*Tompkins Industries, Inc.*



FF6500-08-08

08MORFS-08FORFSX 90

*Tompkins Industries, Inc.*



FF6500-08-12

08MORFS-12FORFSX 90

*Tompkins Industries, Inc.*

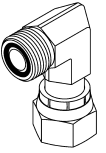

FF6500-10-10

10MORFS-10FORFSX 90

*Tompkins Industries, Inc.*

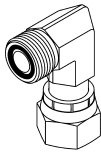

FF6500-12-12

12MORFS-12FORFSX 90

*Tompkins Industries, Inc.*



FF6500-16-16

16MORFS-16FORFSX 90

*Tompkins Industries, Inc.*

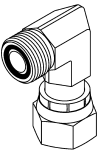

FF6500-20-20

20MORFS-20FORFSX 90

*Tompkins Industries, Inc.*

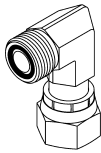

FF6500-24-20

24MORFS-20FORFSX 90

*Tompkins Industries, Inc.*



FF6500-24-24

24MORFS-24FORFSX 90

*Tompkins Industries, Inc.*

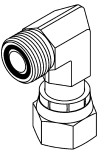

FF6502-04-04

04MORFS-04FORFSX 45

*Tompkins Industries, Inc.*

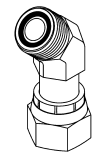

FF6502-06-06

06MORFS-06FORFSX 45

*Tompkins Industries, Inc.*

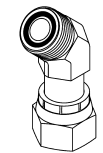

FF6502-08-08

08MORFS-08FORFSX 45

*Tompkins Industries, Inc.*

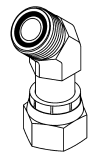

FF6502-10-10

10MORFS-10FORFSX 45

*Tompkins Industries, Inc.*

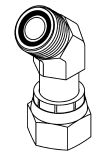

FF6502-12-12

12MORFS-12FORFSX 45

*Tompkins Industries, Inc.*

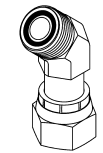

FF6502-16-16

16MORFS-16FORFSX 45

*Tompkins Industries, Inc.*

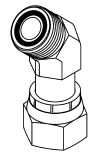

FF6502-20-20

20MORFS-20FORFSX 45

*Tompkins Industries, Inc.*

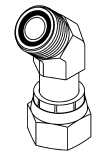

FF6504-04-04

04MJ-04FORFSX

*Tompkins Industries, Inc.*

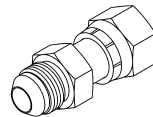

FF6504-06-06

06MJ-06FORFSX

*Tompkins Industries, Inc.*

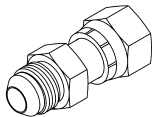

FF6504-06-08

06MJ-08FORFSX

*Tompkins Industries, Inc.*

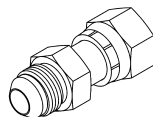

FF6504-08-08

08MJ-08FORFSX

*Tompkins Industries, Inc.*

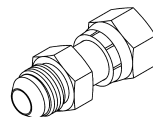

FF6504-10-10

10MJ-10FORFSX

*Tompkins Industries, Inc.*

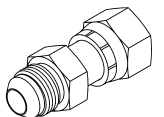

FF6504-12-12

12MJ-12FORFSX

*Tompkins Industries, Inc.*

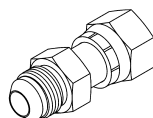

FF6504-16-16

16MJ-16FORFSX

*Tompkins Industries, Inc.*

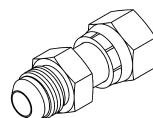

FF6504-20-20

20MJ-20FORFSX

*Tompkins Industries, Inc.*

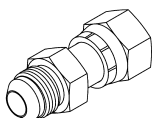

FF6504-24-24

24MJ-24FORFSX

*Tompkins Industries, Inc.*

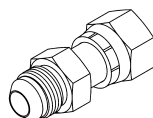

FF6505-04-04

04FORFSX-04MP

*Tompkins Industries, Inc.*

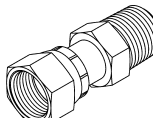

FF6505-06-06

06FORFSX-06MP

*Tompkins Industries, Inc.*

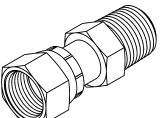

FF6505-08-08

08FORFSX-08MP

*Tompkins Industries, Inc.*

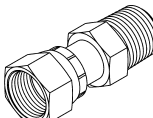

FF6505-10-08

10FORFSX-08MP

*Tompkins Industries, Inc.*

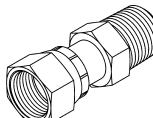

FF6505-12-12

12FORFSX-12MP

*Tompkins Industries, Inc.*

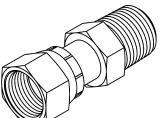

**FF6505-16-16**

16FORFSX-16MP

*Tompkins Industries, Inc.*

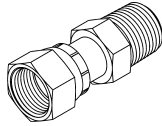

**FF6507-04-04**

04MOR-04FORFSX

*Tompkins Industries, Inc.*

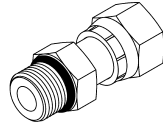

**FF6507-06-06**

06MOR-06FORFSX

*Tompkins Industries, Inc.*

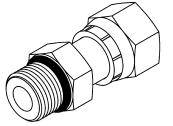

**FF6507-08-08**

08MOR-08FORFSX

*Tompkins Industries, Inc.*

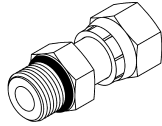

**FF6507-10-10**

10MOR-10FORFSX

*Tompkins Industries, Inc.*

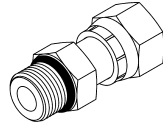

**FF6507-12-12**

12MOR-12FORFSX

*Tompkins Industries, Inc.*

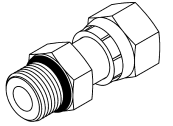

**FF6507-16-16**

16MOR-16FORFSX

*Tompkins Industries, Inc.*

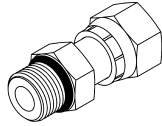

**FF6507-20-20**

20MOR-20FORFSX

*Tompkins Industries, Inc.*

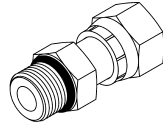

**FF6600-04-04-04**

04MORFS-04MORFS-04FORFSX TEE

*Tompkins Industries, Inc.*

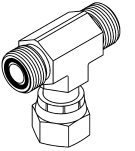

**FF6600-06-06-06**

06MORFS-06MORFS-06FORFSX TEE

*Tompkins Industries, Inc.*

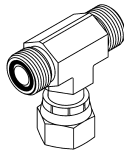

**FF6600-08-08-08**

08MORFS-08MORFS-08FORFSX TEE

*Tompkins Industries, Inc.*

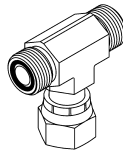

**FF6600-10-10-10**

10MORFS-10MORFS-10FORFSX TEE

*Tompkins Industries, Inc.*

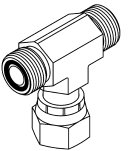

**FF6600-12-12-12**

12MORFS-12MORFS-12FORFSX TEE

*Tompkins Industries, Inc.*

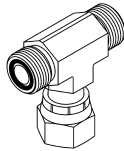

**FF6600-16-16-16**

16MORFS-16MORFS-16FORFSX TEE

*Tompkins Industries, Inc.*

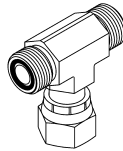

**FF6600-20-20-20**

20MORFS-20MORFS-20FORFSX TEE

*Tompkins Industries, Inc.*

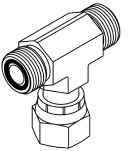

**FF6600-24-24-24**

24MORFS-24MORFS-24FORFSX TEE

*Tompkins Industries, Inc.*

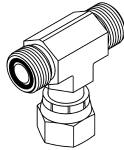

**FF6602-04-04-04**

04MORFS-04FORFSX-04MORFS TEE

*Tompkins Industries, Inc.*

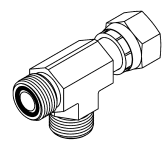

**FF6602-06-06-06**

06MORFS-06FORFSX-06MORFS TEE

*Tompkins Industries, Inc.*

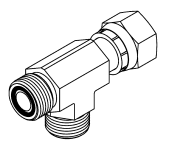

**FF6602-08-08-08**

08MORFS-08FORFSX-08MORFS TEE

*Tompkins Industries, Inc.*

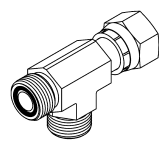

**FF6602-10-10-10**

10MORFS-10FORFSX-10MORFS TEE

*Tompkins Industries, Inc.*

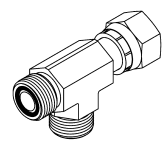

**FF6602-12-12-12**

12MORFS-12FORFSX-12MORFS TEE

*Tompkins Industries, Inc.*

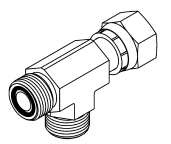

**FF6602-16-16-16**

16MORFS-16FORFSX-16MORFS TEE

*Tompkins Industries, Inc.*

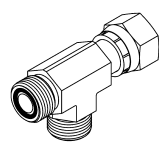

**FF6602-20-20-20**

20MORFS-20FORFSX-20MORFS TEE

*Tompkins Industries, Inc.*

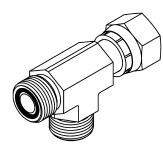

**FF6602-24-24-24**

24MORFS-24FORFSX-24MORFS TEE

*Tompkins Industries, Inc.*

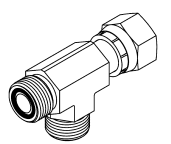

**FF6801-04-04**

04MORFS-04MOR 90

*Tompkins Industries, Inc.*

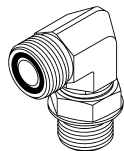

**FF6801-04-05**

04MORFS-05MOR 90

*Tompkins Industries, Inc.*

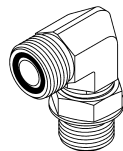

**FF6801-04-06**

04MORFS-06MOR 90

*Tompkins Industries, Inc.*

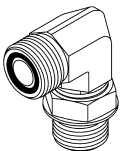

**FF6801-04-08**

04MORFS-08MOR 90

*Tompkins Industries, Inc.*

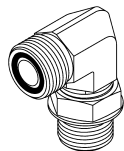

**FF6801-06-04**

06MORFS-04MOR 90

*Tompkins Industries, Inc.*

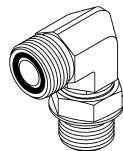

**FF6801-06-05**

06MORFS-05MOR 90

*Tompkins Industries, Inc.*

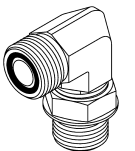

FF6801-06-06

06MORFS-06MOR 90

*Tompkins Industries, Inc.*

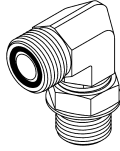

FF6801-06-08

06MORFS-08MOR 90

*Tompkins Industries, Inc.*

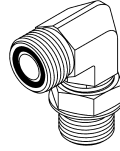

FF6801-06-10

06MORFS-10MOR 90

*Tompkins Industries, Inc.*

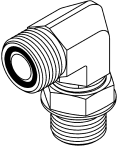

FF6801-06-12

06MORFS-12MOR 90

*Tompkins Industries, Inc.*

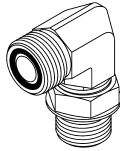

FF6801-06-16

06MORFS-16MOR 90

*Tompkins Industries, Inc.*

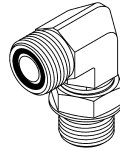

FF6801-08-06

08MORFS-06MOR 90

*Tompkins Industries, Inc.*

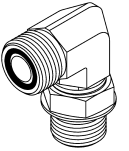

FF6801-08-08

08MORFS-08MOR 90

*Tompkins Industries, Inc.*

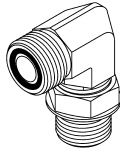

FF6801-08-10

08MORFS-10MOR 90

*Tompkins Industries, Inc.*

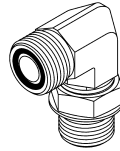

FF6801-08-12

08MORFS-12MOR 90

*Tompkins Industries, Inc.*

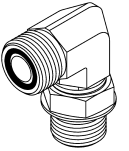

FF6801-10-08

10MORFS-08MOR 90

*Tompkins Industries, Inc.*

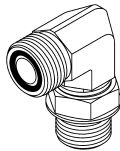

FF6801-10-10

10MORFS-10MOR 90

*Tompkins Industries, Inc.*

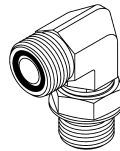

FF6801-10-12

10MORFS-12MOR 90

*Tompkins Industries, Inc.*

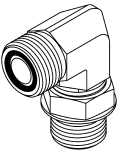

FF6801-12-08

12MORFS-08MOR 90

*Tompkins Industries, Inc.*

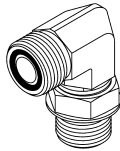

FF6801-12-10

12MORFS-10MOR 90

*Tompkins Industries, Inc.*

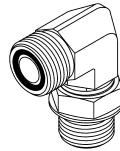

FF6801-12-12

12MORFS-12MOR 90

*Tompkins Industries, Inc.*

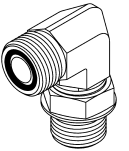

FF6801-12-16

12MORFS-16MOR 90

*Tompkins Industries, Inc.*

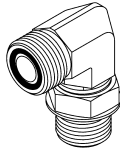

FF6801-16-12

16MORFS-12MOR 90

*Tompkins Industries, Inc.*

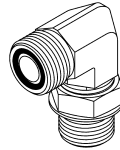

FF6801-16-14

16MORFS-14MOR 90

*Tompkins Industries, Inc.*

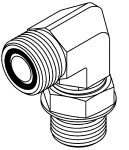

FF6801-16-16

16MORFS-16MOR 90

*Tompkins Industries, Inc.*

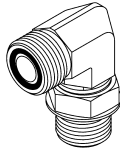

FF6801-16-20

16MORFS-20MOR 90

*Tompkins Industries, Inc.*

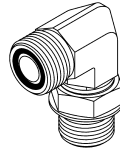

FF6801-20-12

20MORFS-12MOR 90

*Tompkins Industries, Inc.*

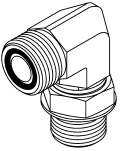

FF6801-20-16

20MORFS-16MOR 90

*Tompkins Industries, Inc.*

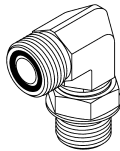

FF6801-20-20

20MORFS-20MOR 90

*Tompkins Industries, Inc.*

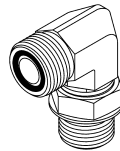

FF6801-20-24

20MORFS-24MOR 90

*Tompkins Industries, Inc.*

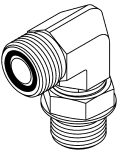

FF6801-24-20

24MORFS-20MOR 90

*Tompkins Industries, Inc.*

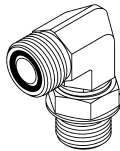

FF6801-24-24

24MORFS-24MOR 90

*Tompkins Industries, Inc.*

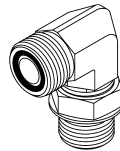

FF6801-L-12-12-3.31

12MFF-12MOR 90 LONG 3.31"

*Tompkins Industries, Inc.*

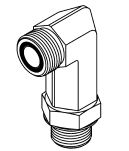

FF6801-LL-04-04-2.23

04MORFS-04MOR 90 EX LONG  
2.23"

*Tompkins Industries, Inc.*

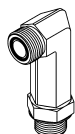

FF6801-LL-06-06-2.61

06MORFS-06MOR 90 EX LONG  
2.61"

*Tompkins Industries, Inc.*

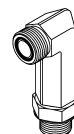

FF6801-LL-08-08-2.95

08MORFS-08MOR 90 EX LONG  
2.95"

*Tompkins Industries, Inc.*

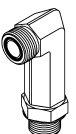

FF6801-LL-10-10-3.51

10MORFS-10MOR 90 EX LONG  
3.51"

*Tompkins Industries, Inc.*

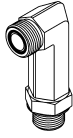

FF6801-LL-12-12-3.97

12MORFS-12MOR 90 EX LONG  
3.97"

*Tompkins Industries, Inc.*



FF6801-LL-16-16-4.51

16MORFS-16MOR 90 EX LONG  
4.51"

*Tompkins Industries, Inc.*

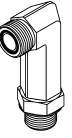

FF6801-LL-20-20-4.98

20MORFS-20MOR 90 EX LONG  
4.98"

*Tompkins Industries, Inc.*

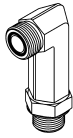

FF6801-LL-24-24-5.48

24MORFS-24MOR 90 EX LONG  
5.48"

*Tompkins Industries, Inc.*

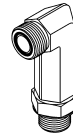

FF6801-LLL-08-08-3.50

08MORFS-08MOR 90 EX-EX  
3.50"

*Tompkins Industries, Inc.*

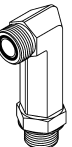

FF6801-LLL-16-16-5.00

16MORFS-16MOR 90 EX-EX  
5.00"

*Tompkins Industries, Inc.*

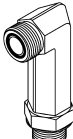

FF6802-04-04

04MORFS-04MOR 45

*Tompkins Industries, Inc.*



FF6802-04-06

04MORFS-06MOR 45

*Tompkins Industries, Inc.*



FF6802-06-04

06MORFS-04MOR 45

*Tompkins Industries, Inc.*



FF6802-06-06

06MORFS-06MOR 45

*Tompkins Industries, Inc.*



FF6802-06-08

06MORFS-08MOR 45

*Tompkins Industries, Inc.*



FF6802-06-10

06MORFS-10MOR 45

*Tompkins Industries, Inc.*



FF6802-08-06

08MORFS-06MOR 45

*Tompkins Industries, Inc.*



FF6802-08-08

08MORFS-08MOR 45

*Tompkins Industries, Inc.*

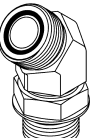

FF6802-08-10

08MORFS-10MOR 45

*Tompkins Industries, Inc.*



FF6802-08-12

08MORFS-12MOR 45

*Tompkins Industries, Inc.*



FF6802-10-08

10MORFS-08MOR 45

*Tompkins Industries, Inc.*



FF6802-10-10

10MORFS-10MOR 45

*Tompkins Industries, Inc.*



FF6802-10-12

10MORFS-12MOR 45

*Tompkins Industries, Inc.*

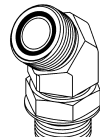

FF6802-12-08

12MORFS-08MOR 45

*Tompkins Industries, Inc.*



FF6802-12-10

12MORFS-10MOR 45

*Tompkins Industries, Inc.*



FF6802-12-12

12MORFS-12MOR 45

*Tompkins Industries, Inc.*



FF6802-12-16

12MORFS-16MOR 45

*Tompkins Industries, Inc.*

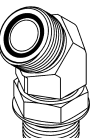

FF6802-16-12

16MORFS-12MOR 45

*Tompkins Industries, Inc.*



FF6802-16-16

16MORFS-16MOR 45

*Tompkins Industries, Inc.*



FF6802-16-20

16MORFS-20MOR 45

*Tompkins Industries, Inc.*



FF6802-20-16

20MORFS-16MOR 45

*Tompkins Industries, Inc.*



FF6802-20-20

20MORFS-20MOR 45

*Tompkins Industries, Inc.*



FF6802-24-24

24MORFS-24MOR 45

*Tompkins Industries, Inc.*

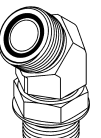

FF6803-04-04-04

04MORFS-04MORFS-04MOR TEE

*Tompkins Industries, Inc.*

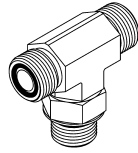

FF6803-04-04-06

04MORFS-04MORFS-06MOR TEE

*Tompkins Industries, Inc.*

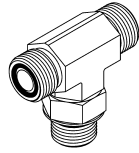

FF6803-06-06-06

06MORFS-06MORFS-06MOR TEE

*Tompkins Industries, Inc.*

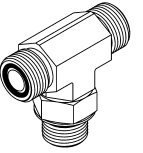

FF6803-06-06-08

06MORFS-06MORFS-08MOR TEE

*Tompkins Industries, Inc.*

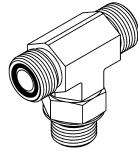

FF6803-08-06-08

08MORFS-06MORFS-08MOR TEE

*Tompkins Industries, Inc.*

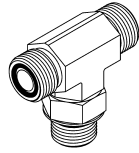

FF6803-08-08-06

08MORFS-08MORFS-06MOR TEE

*Tompkins Industries, Inc.*

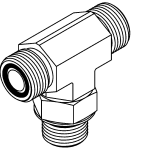

FF6803-08-08-08

08MORFS-08MORFS-08MOR TEE

*Tompkins Industries, Inc.*

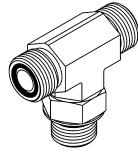

FF6803-08-08-12

08MORFS-08MORFS-12MOR TEE

*Tompkins Industries, Inc.*

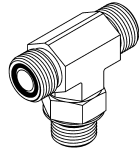

FF6803-10-10-10

10MORFS-10MORFS-10MOR TEE

*Tompkins Industries, Inc.*

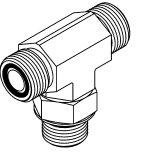

FF6803-12-12-10

12MORFS-12MORFS-10MOR TEE

*Tompkins Industries, Inc.*

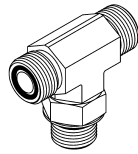

FF6803-12-12-12

12MORFS-12MORFS-12MOR TEE

*Tompkins Industries, Inc.*

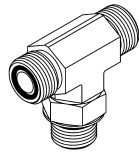

FF6803-12-12-16

12MORFS-12MORFS-16MOR TEE

*Tompkins Industries, Inc.*

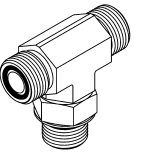

FF6803-12-16-16

12MORFS-16MORFS-16MOR TEE

*Tompkins Industries, Inc.*

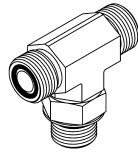

FF6803-16-16-12

16MORFS-16MORFS-12MOR TEE

*Tompkins Industries, Inc.*

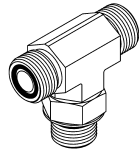

FF6803-16-16-16

16MORFS-16MORFS-16MOR TEE

*Tompkins Industries, Inc.*

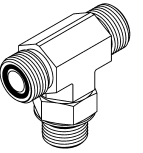

FF6803-20-20-16

20MORFS-20MORFS-16MOR TEE

*Tompkins Industries, Inc.*

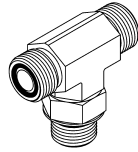

FF6803-20-20-20

20MORFS-20MORFS-20MOR TEE

*Tompkins Industries, Inc.*

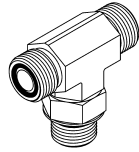

FF6803-24-24-24

24MORFS-24MORFS-24MOR TEE

*Tompkins Industries, Inc.*

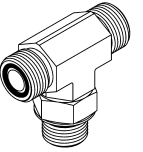

FF6804-04-04-04

04MORFS-04MOR-04MORFS TEE

*Tompkins Industries, Inc.*

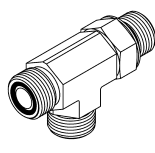

FF6804-04-06-04

04MORFS-06MOR-04MORFS TEE

*Tompkins Industries, Inc.*

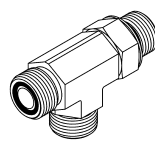

FF6804-06-04-06

06MORFS-04MOR-06MORFS TEE

*Tompkins Industries, Inc.*

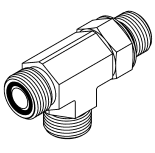

FF6804-06-06-06

06MORFS-06MOR-06MORFS TEE

*Tompkins Industries, Inc.*

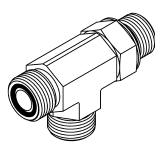

FF6804-08-06-08

08MORFS-06MOR-08MORFS TEE

*Tompkins Industries, Inc.*

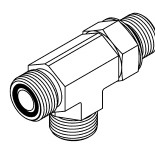

FF6804-08-08-08

08MORFS-08MOR-08MORFS TEE

*Tompkins Industries, Inc.*

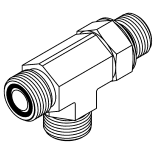

FF6804-08-10-08

08MORFS-10MOR-08MORFS TEE

*Tompkins Industries, Inc.*

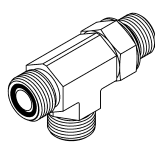

FF6804-08-12-08

08MORFS-12MOR-08MORFS TEE

*Tompkins Industries, Inc.*

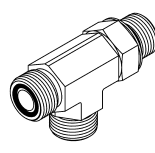

FF6804-10-10-10

10MORFS-10MOR-10MORFS TEE

*Tompkins Industries, Inc.*

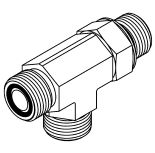

FF6804-10-12-10

10MORFS-12MOR-10MORFS TEE

*Tompkins Industries, Inc.*

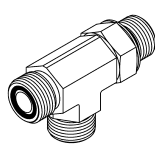

FF6804-10-12-12

10MORFS-12MOR-12MORFS TEE

*Tompkins Industries, Inc.*

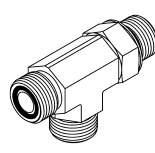

FF6804-12-12-08

12MORFS-12MOR-08MORFS TEE

*Tompkins Industries, Inc.*

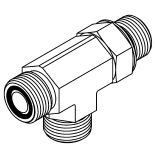

**FF6804-12-12-12**

12MORFS-12MOR-12MORFS TEE

*Tompkins Industries, Inc.*

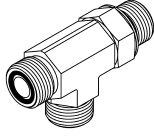

**FF6804-12-16-12**

12MORFS-16MOR-12MORFS TEE

*Tompkins Industries, Inc.*

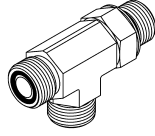

**FF6804-16-12-16**

16MORFS-12MOR-16MORFS TEE

*Tompkins Industries, Inc.*

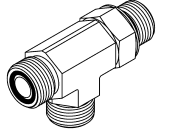

**FF6804-16-16-12**

16MORFS-16MOR-12MORFS TEE

*Tompkins Industries, Inc.*

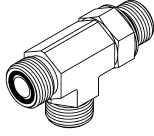

**FF6804-16-16-16**

16MORFS-16MOR-16MORFS TEE

*Tompkins Industries, Inc.*

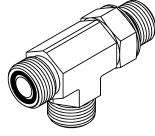

**FF6804-20-16-20**

20MORFS-16MOR-20MORFS TEE

*Tompkins Industries, Inc.*

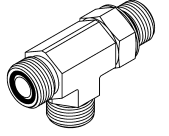

**FF6804-20-20-20**

20MORFS-20MOR-20MORFS TEE

*Tompkins Industries, Inc.*

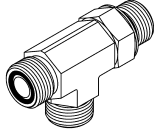

**FF6804-24-24-24**

24MORFS-24MOR-24MORFS TEE

*Tompkins Industries, Inc.*

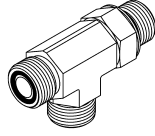

**FF6809-04-04**

04MOR-04FORFSX 90

*Tompkins Industries, Inc.*

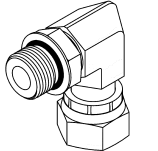

**FF6809-06-06**

06MOR-06FORFSX 90

*Tompkins Industries, Inc.*

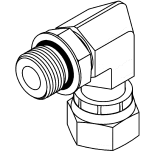

**FF6809-08-08**

08MOR-08FORFSX 90

*Tompkins Industries, Inc.*

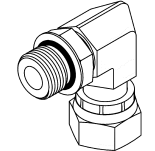

**FF6809-10-10**

10MOR-10FORFSX 90

*Tompkins Industries, Inc.*

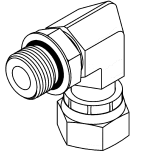

**FF6809-12-12**

12MOR-12FORFSX 90

*Tompkins Industries, Inc.*

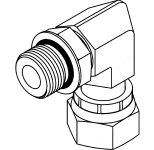

**FF6809-16-16**

16MOR-16FORFSX 90

*Tompkins Industries, Inc.*

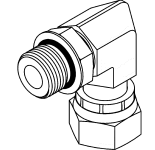

**FF6809-20-20**

20MOR-20FORFSX 90

*Tompkins Industries, Inc.*

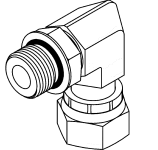

**FF6809-24-24**

24MOR-24FORFSX 90

*Tompkins Industries, Inc.*

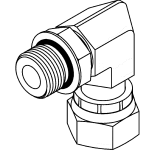

**SBR-04**

04 SILVER BRAZE RING

*Tompkins Industries, Inc.*



**SBR-06**

06 SILVER BRAZE RING

*Tompkins Industries, Inc.*



**SBR-08**

08 SILVER BRAZE RING

*Tompkins Industries, Inc.*



**SBR-10**

10 SILVER BRAZE RING

*Tompkins Industries, Inc.*



**SBR-12**

12 SILVER BRAZE RING

*Tompkins Industries, Inc.*



**SBR-16**

16 SILVER BRAZE RING

*Tompkins Industries, Inc.*



**SBR-20**

20 SILVER BRAZE RING

*Tompkins Industries, Inc.*



**SBR-24**

24 SILVER BRAZE RING

*Tompkins Industries, Inc.*

